

PISTON PUMP

TYPE : 41cc BENT AXIS PISTON PUMP

CODE : 35404131/32



SPECIFICATIONS

Displacement	: 41 cm ³ /dev.
Working Pressure	: 300 bar
Max.intermittent pressure	: 350 bar
Max.peak pressure	: 400 bar
Max.continuous speed	: 1200 1/dak
Max.speed at intermit. pressure	: 2000 1/dak
Oil temperature range	: -20 & 80 °C
Oil inlet diameter - C	: Ø44
Oil Outlet diameter - D	: R 3/4"
Weight	: 10 kg

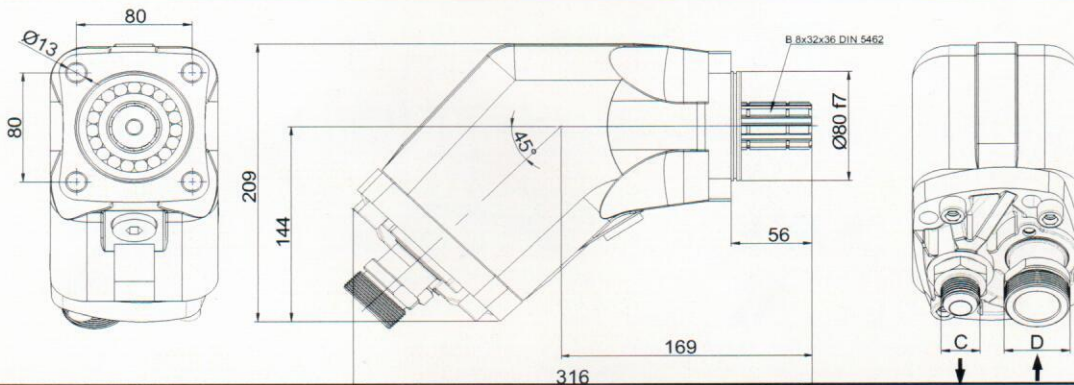

PERFORMANCE GRAPH



PRESSURE DEFINITION

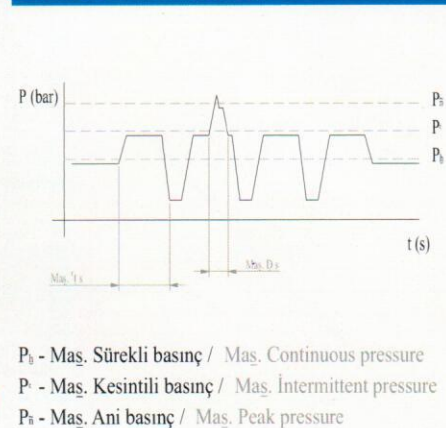

ChNo	Name1	Min	MinTime	Max	MaxTime	Unit	ChNo	Name1	Min	MinTime	Max	MaxTime	Unit
ch2	Devir	0.0	19.08.2009 10:14:01	3336.5	19.08.2009 10:15:44	dev/dk	ch5	Debi	0.0	19.08.2009 10:14:04	99.0	19.08.2009 10:15:44	l/min
ch3	Sıcaklık	35.0	19.08.2009 10:14:01	39.0	19.08.2009 10:15:47	°C	ch7						
ch4	Tork	2.0	19.08.2009 10:14:01	7.0	19.08.2009 10:15:34	N	ch6						
ch1	Basınç	1.0	19.08.2009 10:14:01	227.0	19.08.2009 10:15:44	bar							

PISTON PUMP

TYPE : 51cc BENT AXIS PISTON PUMP
CODE : 35405131/32



SPECIFICATIONS

Displacement	: 51 cm ³ /dev.
Working Pressure	: 300 bar
Max.intermittent pressure	: 350 bar
Max.peak pressure	: 400 bar
Max.continuous speed	: 1200 1/dak
Max.speed at intermit. pressure	: 2000 1/dak
Oil temperature range	: -20 & 80 °C
Oil inlet diameter - C	: Ø44
Oil Outlet diameter - D	: R 3/4"
Weight	: 9,5 kg

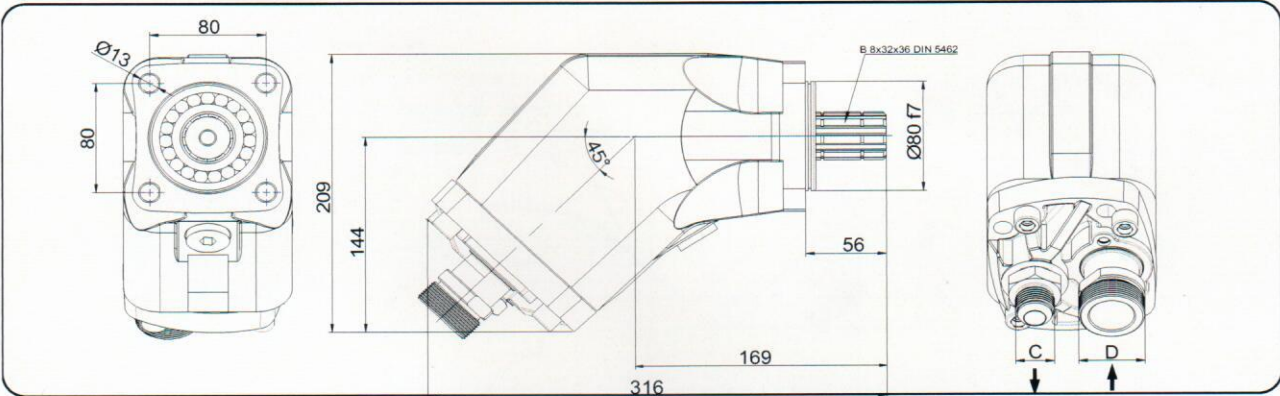

PERFORMANCE GRAPH



PRESSURE DEFINITION

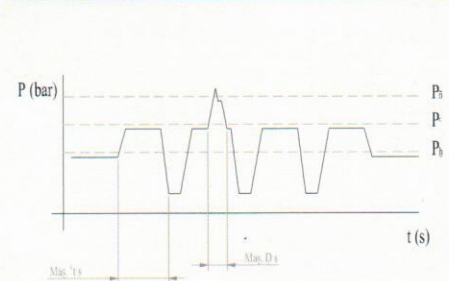

P_c - Maş. Sürekli basınç / Maş. Continuous pressure
P_i - Maş. Kesintili basınç / Maş. İntermittent pressure
P_a - Maş. Ani basınç / Maş. Peak pressure

PISTON PUMP

TYPE : 61cc BENT AXIS PISTON PUMP
 CODE : 35406131/32



SPECIFICATIONS

Displacement	: 61 cm ³ /dev.
Working Pressure	: 300 bar
Max.intermittent pressure	: 350 bar
Max.peak pressure	: 400 bar
Max.continuous speed	: 1200 1/dak
Max.speed at intermit. pressure	: 2000 1/dak
Oil temperature range	: -20 & 80 °C
Oil inlet diameter - C	: Ø44
Oil Outlet diameter - D	: R 3/4"
Weight	: 10 kg

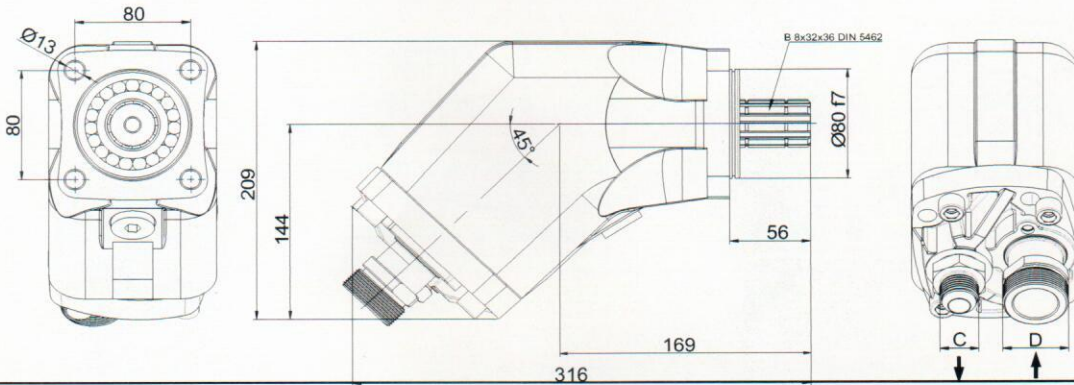

PERFORMANCE GRAPH



ChNo	Name1	Min	MinTime	Max	MaxTime	Unit	ChNo	Name1	Min	MinTime	Max	MaxTime	Unit
ch1	Devir	0.0	19.08.2009 10:14:01	338.5	19.08.2009 10:15:44	dev/dak	ch5	Basinc	0.0	19.08.2009 10:14:04	99.0	19.08.2009 10:15:44	l/min
ch2	Sicaklik	35.0	19.08.2009 10:14:01	39.0	19.08.2009 10:15:47	°C	ch6		-	-	-	-	-
ch3	Tork	2.0	19.08.2009 10:14:01	76.0	19.08.2009 10:15:34	N	ch7		-	-	-	-	-
ch4	Basinc	1.0	19.08.2009 10:14:01	227.0	19.08.2009 10:15:44	bar	ch8		-	-	-	-	-

PRESSURE DEFINITION

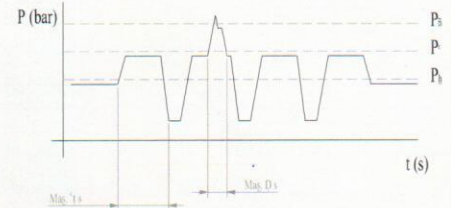

P_p - Maş. Sürekli basınç / Maş. Continuous pressure
 P - Maş. Kesintili basınç / Maş. İntermittent pressure
 P_i - Maş. Ani basınç / Maş. Peak pressure

PISTON PUMP

TYPE : 81 cc BENT AXIS PISTON PUMP
 CODE : 35408131/32



SPECIFICATIONS

Displacement	: 81 cm ³ /dev.
Working Pressure	: 300 bar
Max.intermittent pressure	: 350 bar
Max.peak pressure	: 400 bar
Max.continuous speed	: 1200 1/dak
Max.speed at intermit. pressure	: 2000 1/dak
Oil temperature range	: -20 & 80 °C
Oil inlet diameter - C	: R 1 1/4"
Oil Outlet diameter - D	: R 3/4"
Weight	: 14 kg

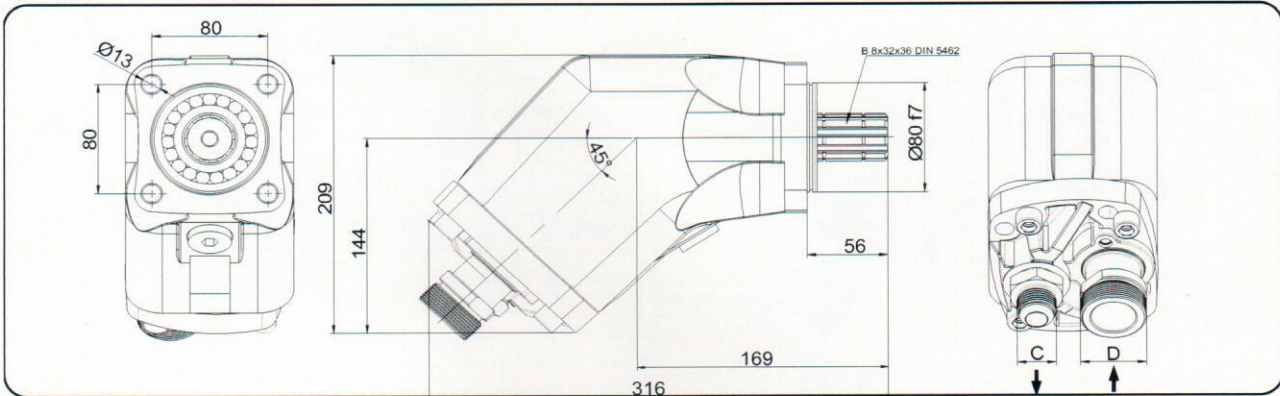

PERFORMANCE GRAPH

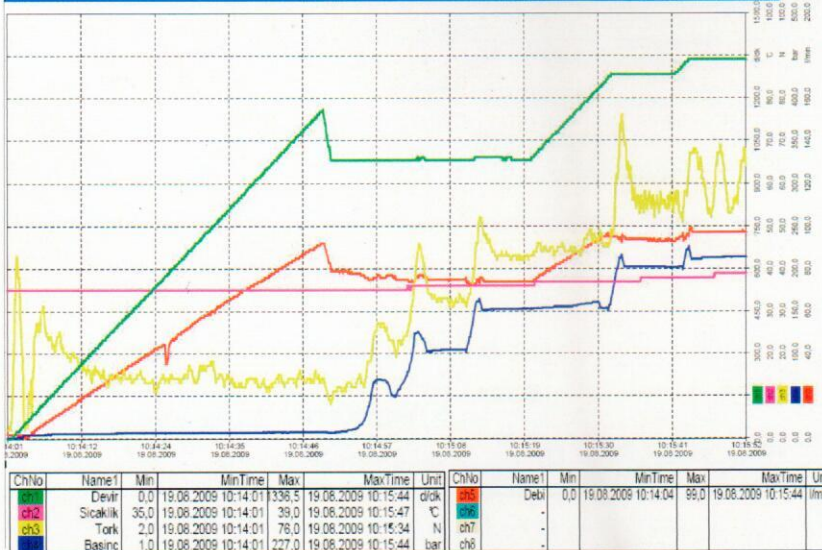

PRESSURE DEFINITION

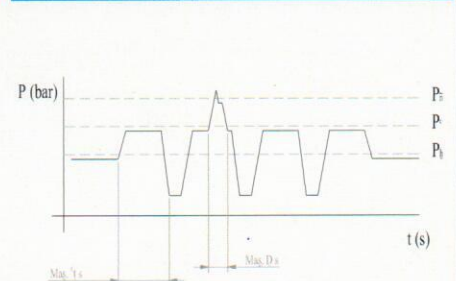

P_n - Maş. Sürekli basınç / Maş. Continuous pressure
 P - Maş. Kesintili basınç / Maş. Intermittent pressure
 P_a - Maş. Ani basınç / Maş. Peak pressure

PISTON PUMP

TYPE : 101cc BENT AXIS PISTON PUMP
CODE : 35410131/32



SPECIFICATIONS

Displacement	: 101 cm ³ /dev.
Working Pressure	: 300 bar
Max.intermittent pressure	: 350 bar
Max.peak pressure	: 400 bar
Max.continuous speed	: 1200 1/dak
Max.speed at intermit. pressure	: 2000 1/dak
Oil temperature range	: -20 & 80 °C
Oil inlet diameter - C	: Ø44
Oil Outlet diameter - D	: R 1"
Weight	: 14 kg

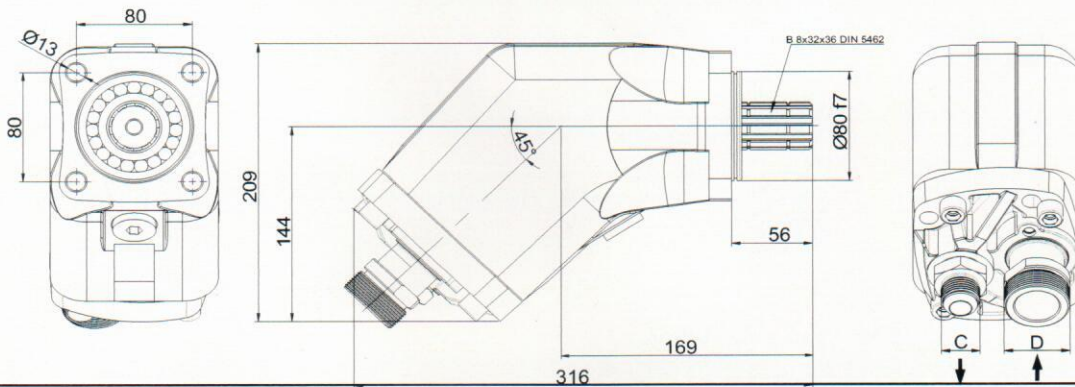

PERFORMANCE GRAPH



ChNo	Name1	Min	MinTime	Max	MaxTime	Unit	ChNo	Name1	Min	MinTime	Max	MaxTime	Unit
ch1	Devir	0,0	02.07.2009 14:17:31	381,5	02.07.2009 14:19:14	devir	ch2	Sıcaklık	36,0	02.07.2009 14:17:31	40,0	02.07.2009 14:19:14	°C
ch3	Tork	2,0	02.07.2009 14:17:31	75,0	02.07.2009 14:19:22	N	ch7						
ch4	Basınc	2,0	02.07.2009 14:17:31	218,0	02.07.2009 14:18:58	bar	ch8						

PRESSURE DEFINITION

